

MOTOSIERRA A GASOLINA 52 CC

Parte: **MOTOSIERRA**

Código **489856**

Modelo **XCS52-I**

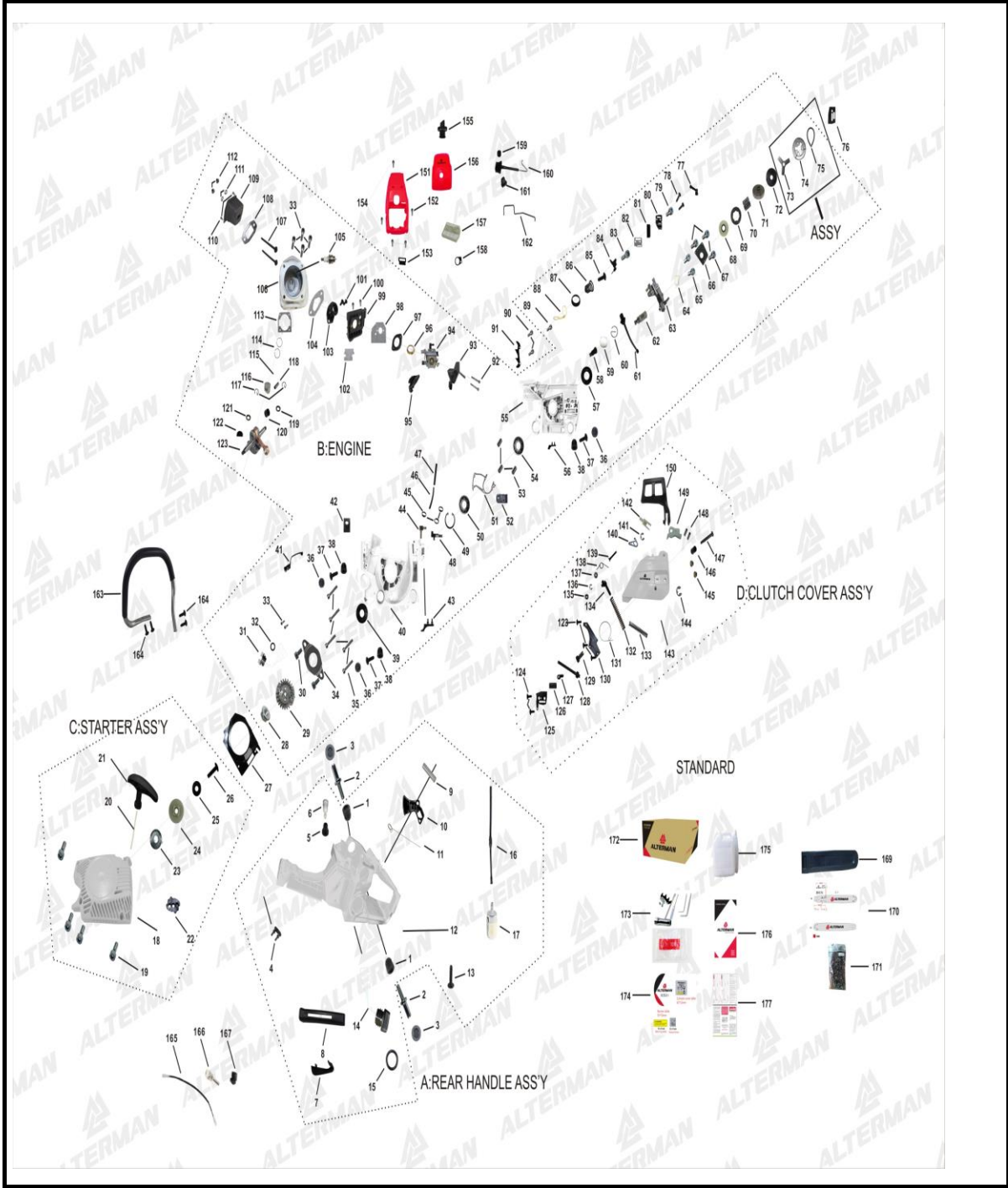

MOTOSIERRA A GASOLINA 52 CC

Parte: MOTOSIERRA

Código 489856

Modelo XCS52-I

N°	Cód. Savake	Descripción Español	Descripción Ingles	Cant.	Observaciones
1	491852	KIT DE DAMPERS P/XCS52-I /XCS62-I	DAMPER ASS'Y-	2	
2			LONG DAMPING SCREW	2	
3			BIG DUST CAP	2	
4			DOUBLE-HEADED SCREW DAMPER	1	
5			BALANCER PLATE	1	
6			BREATHER	1	
7			THROTTLE INTERLOCK ARM	1	
8			REAR HANDLE COVER	1	
9			BREATHER PIPE	1	
10			THROTTLE LEVER	1	
11			THROTTLE SPRING	1	
12	521641	TANQUE DE COMBUSTIBLE P/XCS52-I/XCS62-I	FUEL TANK	1	
13			SCREW (ST4.8*20)	1	
14			LINK+FUEL TANK CAP	1	
15			FUEL TANK CAP WASHER	1	
16	491811	FILTRO DE COMBUSTIBLE P/XCS52-I/XCS62-I	FUEL PIPE	1	
17			FUEL FILTER ASS'Y	1	
18			STARTER COVER	1	
19	491795	ARANQUE COMPLETO P/XCS52-I /XCS62-I	SCREW(M5*14)	12	
20			NYLON ROPE	1	
21			STARTER KNOB	1	
22			GUIDE(LH)	1	
23			RECOIL SPRING	1	
24			STARTER REEL	1	
25			REEL WASHER	1	
26			SCREW(ST4.8*16)	1	
27			FAN COVER	1	
28			NUT M8	1	
29			FLYWHEEL ASS'Y	1	
30			SCREW(M4*8)	2	
31			OIL TANK COVER	1	
32			OIL TANK CAP GASKET	1	
33			SCREW(M5*20)	2	
34			PLATE	1	

MOTOSIERRA A GASOLINA 52 CC

0 MOTOSIERRA

Código 489856

Modelo XCS52-I

N°	Cód. Savake	Descripción Español	Descripción Ingles	Cant.	Observaciones
35			SCREW(M5*25)	5	
36			CAP(SMALL)	3	
37			SCREW(ST4.8*16)	3	
38			DAMPER ASS'Y	3	
39			OIL SEAL	1	
40			LEFT CRANKCASE	1	
41	491787	BOBINA DE ENCENDIDO P/XCS52-I /XCS62-I	INGITION ASS'Y	1	
42			DUST SHIELD	1	
43			STOOPER(L)	1	
44			ELBOW	1	
45			CLIP	2	
46			VACUUM PIPE	1	
47			VACUUM INSULATED SLEEVE	1	
48			ADJUSTMENT GUIDE SLEEVE	1	
49			SNAP RING	1	
50			BALL BEARING	2	
51			CRANKCASE GASKET	1	
52			DUST SHIELD	1	
53			SPRING PIN	3	
54			BALL BEARING	2	
55			RIGHT CRANKCASE	1	
56			STOPPER<R>	1	
57			OIL SEAL	1	
58			MOUTH VENTILATION	1	
59			SPONGE	1	
60			RING	1	
61	534735	MANGUERA Y FILTRO ACEITE P/XCS62-I/XCS52-I	OIL PUMP PIPE(I)	1	
62			OIL FILTER	1	
63	491845	BOMBA DE ACEITE P/XCS52-I/ XCS62-I	OIL PUMP ASS'Y	1	
64			SPONGE	1	
65			SCREW(M4*14)	2	
66			OIL PUMP COVER	1	
67			SCREW(M4*10)	3	
68	491803	SIN FIN BOMBA DE ACEITE P/XCS52-I/XCS62-I	OIL PUMP WORM	1	

MOTOSIERRA A GASOLINA 52 CC

MOTOSIERRA

Código 489856

Modelo XCS52-I

N°	Cód. Savake	Descripción Español	Descripción Ingles	Cant.	Observaciones
69	551259	ANILLO FLOTANTE P/XCS52-I	SPROCKET	1	
70	521633	RODAMIENTO DE AGUJA P/CAMPANA P/XCS52-I/XCS62-I	NEEDLE BEARING	1	
71	491860	CAMPANA DE EMBRAGUE P/XCS52-I /XCS62-I	CLUTCH DRUM	1	
72		0	CLUTCH WASHER	1	
73	512855	EMBRAGUE COMPLETO P/ P/XCS52-I/XCS62-I	Clutch Assy	1	
74					
75					
74				3	
75			CLUTCH SPRINGS	1	
76			BRAKE BASE PLATE	1	
77			OIL PUMP PIPE(O)	1	
78			STUD(M8*42)	2	
79			SCREW(M4*10)	3	
80			OIL GUIDE PLATE	1	
81			CHAIN GUIDE	1	
82			OIL GUIDE PLATE GASKET	1	
83			SCREW(M5*14)	1	
84			CHAIN CATCHER	1	
85			SCREW(ST4.8*16)	1	
86			SPRING	1	
87			SPRING SET	1	
88			GROUND PLATE	1	
89			SCREW(M5*10)	3	
90			SCREW(M5*10)	3	
91			WOOD TOOTH	1	
92			SCREW (M5*50)	2	
93			MANIFOLD	1	
94	491829	CARBURADOR P/XCS52-I	CARBURETOR-52cc/58cc/62cc	1	
95			GUIDE(T)	1	
96			INLET PIPE GUIDE	1	
97			ASBESTOS MAT	1	

Código 489856

Modelo XCS52-I

N°	Cód. Savake	Descripción Español	Descripción Ingles	Cant.	Observaciones
98			CARBURATOR GASKET	1	
99			CARBURATOR BRACKET	1	
100			SCREW(M5*14)	2	
101			SCREW(M5*12)	2	
102			UNDER MAT	1	
103	534743	INSULADOR P/ XCS62-I/XCS52-I	INLET PIPE	1	
104			PIPE GASKET	1	
105			SPARK PLUG	1	
106	491837	CILINDRO COMPLETO P/XCS52-I	CYLINDER	1	
114			PISTON RING (45mm/52c)	2	
116			Piston(45mm/52cc)	1	
117			CIRCLIP-11*1.0mm/52cc & 54.5cc same	2	
118			PISTON PIN (11*36.8mm-52cc/54.5cc same)	1	
107			MUFFLER BOLT	2	
108	534727	EXOSTO P/ XCS52-I	MUFFLER GASKET	1	
109			MUFFLER	1	
110			SCREW(M5*12)	2	
111			SPRING WASHER	2	
112			MUFFLER NUT M5	2	
113			CYLINDER GASKET -dia:50mm (52cc/54.5cc Same)	1	
114	491779	ANILLOS DEL PISTON P/XCS52-I	PISTON RING (45mm/52c)	2	
114	491761	PISTON COMPLETO P/XCS52-I	PISTON RING (45mm/52c)	2	
116			Piston(45mm/52cc)	1	
117			CIRCLIP-11*1.0mm/52cc & 54.5cc same	2	
118			PISTON PIN (11*36.8mm-52cc/54.5cc same)	1	
119			WASHER	2	
120	521625	RODAMIENTO DE AGUJA P/PISTON P/XCS52-I	NEEDLE BEARING- K11*15*12.5mm (52cc/54.5cc same)	1	
121			WASHER	2	

MOTOSIERRA

Código 489856

Modelo XCS52-I

N°	Cód. Savake	Descripción Español	Descripción Ingles	Cant.	Observaciones
122			KEY	1	
123	491878	CIGÜEÑAL CON BIELA P/XCS52-I	CRANKSHAFT COMP (52cc, Crank radius-15.5mm)	1	
124	491886	TAPA DEL FRENO COMPLETA P/XCS52-I/XCS62-I	SCREW(M4*8)	5	
125			TENSIONED PLATE	1	
126			CHAIN GUIDE	1	
127	534701	TENSOR DE CADENA P/XCS62-I /XCS52-I	TENSIONER PIN	1	
128			TENSIONED BOLT	1	
129			ADJUST DRIVE GEAR	1	
130			BRAKE SPRING COVER	1	
131			BRAKE BAND	1	
132			BRAKE SPRING(MAIN)	1	
133			BRAKE SPRING(SUB)	3	
134			BRAKE ARM	1	
135			BRAKE GASKET	1	
136			SPLIT WASHERφ3	1	
137			PLATE WASHER	1	
138			RECOIL SPRING	1	
139			STOP PIN	1	
140			STOPPER PLATE	1	
141			SPLIT WASHERφ3.5	1	
142			BRAKE LEVER(SUB)	1	
143			CLUTCH COVER	1	
144			SPLIT WASHERφ4	1	
145			NUT M8	2	
146			HOLLOW PIN	1	
147			GUIDE PIN	1	
148			GUIDE PIN SLEEVE	2	
149			BRAKE LEVER(MAIN)	1	
150			FRONT HAND GUARD	1	
151			CYLINDER TOP COVER	1	
152			SCREW(M5*14)	3	
153			TRANSVERTER OF WINTER&SUMME	1	
154			SCREW(M5*20)	2	
155			NUT	1	
156			AIR FILTER COVER	1	
157			AIR FILTER	1	
158			AIR FILTER WASHER	1	
159			CHOKE ROD GUIDE	1	
160			CHOKE KNOB	1	



MOTOSIERRA A GASOLINA 52 CC

MOTOSIERRA

Código 489856

Modelo XCS52-I

N°	Cód. Savake	Descripción Español	Descripción Ingles	Cant.	Observaciones
161			CHOKE ROD DAMPER	1	
162			THROTTLE ROD	1	
163			FRONT HANDLE COMP	1	
164			SCREW(ST4.8*16)	8	
167			SWITCH(ON/OFF)	1	
168			SWITCH COVER	1	
169			BAR COVER	1	
170			GUIDE BAR	1	
171			CHAIN	1	
172			COLOR BOX	1	
173			TOOL BAG	1	
174			STICKER	1	
175			OIL BOTTLE	1	
176			MANUAL	1	
177			WARRANTY CARD	1	